



ITALIAN  
LIFT  
PASSION





# INGENUITY. GLOBALLY.

Our company was founded in 1989 around two core assets, its brand and its people. And, we believe in the principle idea of providing our clients, and or customers with flexible lift solutions. Now, we're one of the best known elevator brands in the world - present in more than 40 countries around the globe.

Since then, Axel has grown to become synonymous with exceptional quality and reliability with the use of precision technology together with exceptional manual craftsmanship. "Headquartered in Milan (Italy), the company is organized in three units: project management, lift and controller manufacturing, thus ensuring flexibility and an exceptional fast response time. It's common for Axel to provide lifts within a few weeks from the receipt of order. The Axel range is based on an OEM approach of the business: we deliver our products to lift companies and supply them with the technical support in order for them to service their customers. Moreover, we are one of the few lift companies in the world who can design, develop and tailor-produce customize "Bespoke" solutions to meet the specific wishes, desires, dreams and needs of our clients, and or customers who are architects, developers and engineers who request exclusive individual lifts for their project(s).



At Axel, we remove chance from the equation by providing superb results consistently in our factory. We are a results driven organization. Therefore, quality control is taken very serious and this starts with our suppliers. We only accept first class products onto our production line that have been approved by our in-house buying team. And, each lift is tested from inception to completion by our experienced "Quality Control Managers" before delivered to customers.

Quality, functionality, engineering and design are all present in every lift manufactured by Axel down to the smallest details.

Come discover the company and the people behind the brand.





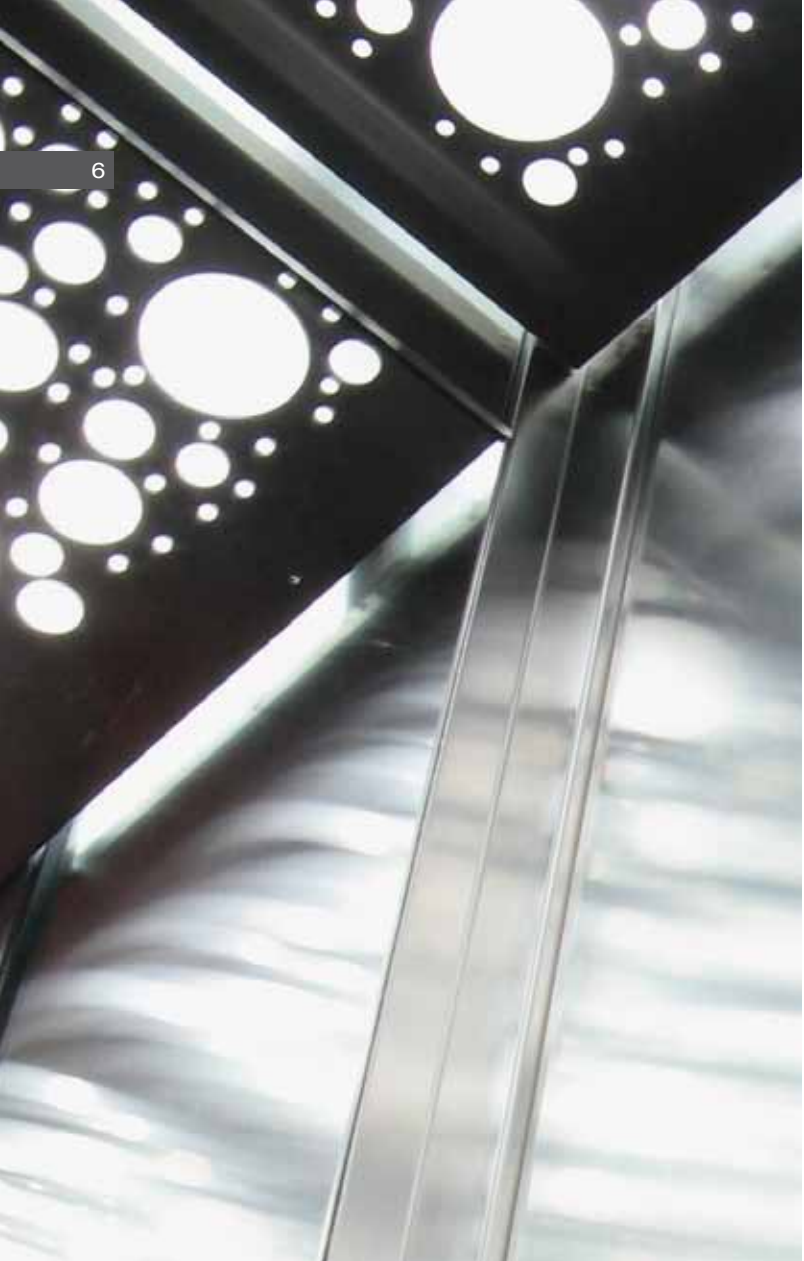

A MARRIAGE  
OF STAINLESS STEEL  
AND GLASS...

BECOMES  
PANORAMIC VISIONS

## QUALITY & ENVIRONMENT MANAGEMENT SYSTEMS

At Axel, all of our components and materials are carefully selected to ensure natural resources are used in a manner which does not adversely affect the environment. All supplier-side items used in our production methodology are selected using strict criteria. The elevator factory in Milan has lead by example with taken a leading role in reducing its energy consumption levels.

Since 1996, Axel has been at the forefront involving quality and quality assurance within its manufacturing processes by becoming one of the first lift companies to obtain ISO 9001 approval (and vision 2000). In addition, Axel gained approval in accordance to the Lift Directive (95/16/EC - schedule XIII). Therefore, all of our lifts comply with the European standard EN81. We also design, engineer and manufacture lifts according to Russian standards, Britain's DDA and other standards upon request.

Each of our lifts are handled as a separate project and is fully documented and traceable through all stages of its elaboration for its Management of environmental issues.



## INNOVATIVE PRODUCTION TECHNOLOGY & CRAFTSMANSHIP

Axel lifts are manufactured in our factory in Milan, Italy since 1989 using only the highest quality materials, fittings and production methods. Every processing stage is carefully carried out, checked and monitored. And, only after the completion of these stages is the product passed as acceptable to be used in the end product.

An ongoing certification of Quality Management system supports the company's self-imposed philosophy of delivering only the best product to our clients, and or customers.



## LONG LIFESPAN TESTED

To ensure you can enjoy your elevator for many years to come all materials used are subjected to a number of endurance tests to make sure they will stand up to the rigors of every day life use.

As you would expect only the best results are acceptable.



## AXEL INTELLIGENT TECHNOLOGY POWERS ROBOTICS

Axel has pioneered an intelligent technology that interacts with robotic systems, and allows the robots to assume full control of lift operations.

The inputs and outputs are communicated via CAN Bus Technology from the lift microprocessor to the I/O panel of the robot WAGO Panel connected to the host server. The robot controls door opening and closing operations, floor selections and any external lift landing call requests via a swipe card security system.





## BRILLIANCE

Axel lifts offers beautiful stainless steel, aluminum, glass, real wood veneer laminate; high gloss lacquered finishes, etc. And, our artistic nature, creativity and vast experience in using these materials give our lifts an unrivalled depth and uniformity to them.

A thorough understanding of the materials we use in our production methods and a keen eye for detail ensures the material attributes are as uniformed as possible, as we use very strict criteria in the selection process of our materials.

The color, grain and moisture content of the wood must meet the very stringent quality standards required for Axel lifts in order to make it to the production process.



## BED LIFTS

Lift cars for beds & goods lifts with special material suitable for medical and clinic environments, anti-slip car floor, bump rails and accessories as per following page.



### Hospital Lifts

- A wide variety of capacities for general passenger use
- Service capacities for hospital service use
- Rises up to 40 Mts
- Multi-car group configurations
- VVVF Car door operator with single/double door panel on side opening
- Central opening door
- Front and rear-opening configurations



## ECO SOLUTIONS

### WE SAVE ENERGY

Axel Lift is environmentally friendly and economical in the use of energy, which contributes to lower operating expenses.



### MRL MACHINE ROOMLESS CONTROL BOARD

Beyond the standard model, the main controller is available also in MRL version with built-in power recovery drive.



### ECL PRE-WIRED CONTROL SYSTEM WITH POWER RECOVERY DRIVE

A further development of our control system is the pre-wired "Can" system, which greatly reduces site time and reduces the chances of wrong connections over the hard wired system.

Each complete control system is tested with all the job specific external equipment connected and proved. The shaft wiring excluding the safety circuits are all pre-wired, as are the push buttons and indicators which all plug together and are easily marked to avoid problems.

The car is completely pre-wired with only the trailing cable to be inserted at either end.

The "ECL" system has been extensively tested, not only in the factory but on many different sites covering the whole Axel SRL product range, hydraulic, traction and high speed VVVF drives.



## ENERGY SAVING WITH ENERGY RECOVER TECHNOLOGY

- MRL gearless uses up to 50% less energy than traction drive and 70% less energy than hydraulic drive.
- 50% of the energy used by an elevator can be recovered by regenerative device.
- LED lights use 80% less energy and last up to 10 times longer than halogen lights.
- Generally, 50/70% energy savings can be achieved with a full modernization of the elevator.



## GEARED/GEARLESS MRL

Axel Geared/Gearless (Machine Room Less) Lift is the latest in innovative elevator programmes.

### Key Benefits

- Space Saving: no machine room means maximum utilization of building space within all relevant regulations.
- Energy Saving: MRL Gearless saves you up to 40-50% on energy running costs, thanks to the Permanent Magnet Gearless Drive system.
- Cost Saving: lower construction costs because there is no need to build a machine room.
- Building design flexibility: no visible machine room gives the architect more flexibility in the building's design.
- Superior Ride Comfort: MRL Gearless delivers unparalleled precision and ride comfort for this class of MRL elevator.
- Durable: safety for the long term, components and sub-systems have passed very severe tests.



# MRL LIFTS

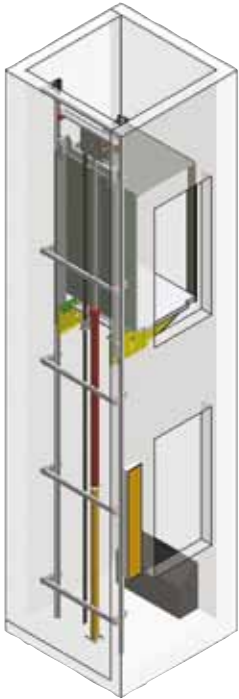

MACHINE ROOM LESS  
HYDRAULIC

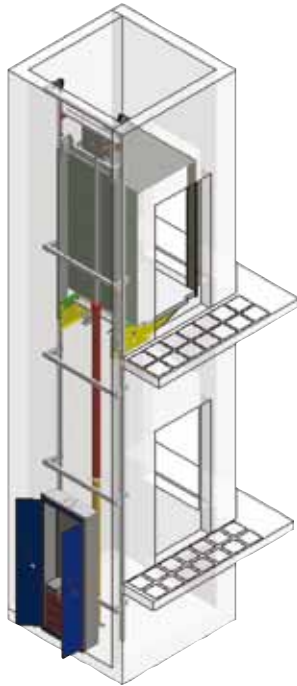

MACHINERY CABINET  
HYDRAULIC

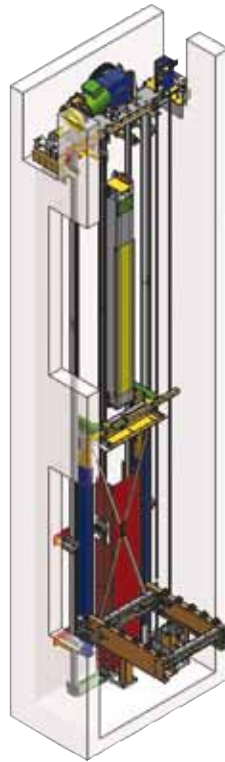

CONSOL  
GEARBOX



ECLIPSE  
GEARBOX

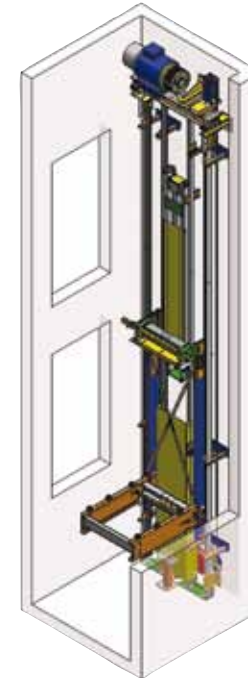

ZEUS  
GEARLESS



EXEL  
GEARLESS

# PRODUCT RANGE

Current product offering includes: complete hydraulic and traction lifts (up to loads of 10,000 and 5,000 kg respectively), MRL lifts in both hydraulic and traction drive (up to loads of 2,000 kg) - geared and gearless - , lift cars and car frames, structures and controllers.

In addition, Axel can provide components and spares such as cabin and landing doors, traction motors and gear boxes, pump units, panels and push buttons, control boards, lift accessories...

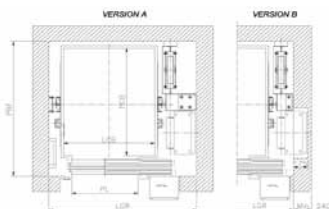

PROJECTS  
& ENGINEERING



GEARBOX  
& GEARLESS



MRL  
HYDRAULIC UNITS



SHAFT  
STRUCTURES



DOORS  
& OPERATORS



COP - PUSHES  
& INDICATORS



CONTROLLERS  
& PRE-WIRINGS



CUSTOMIZED  
CARS



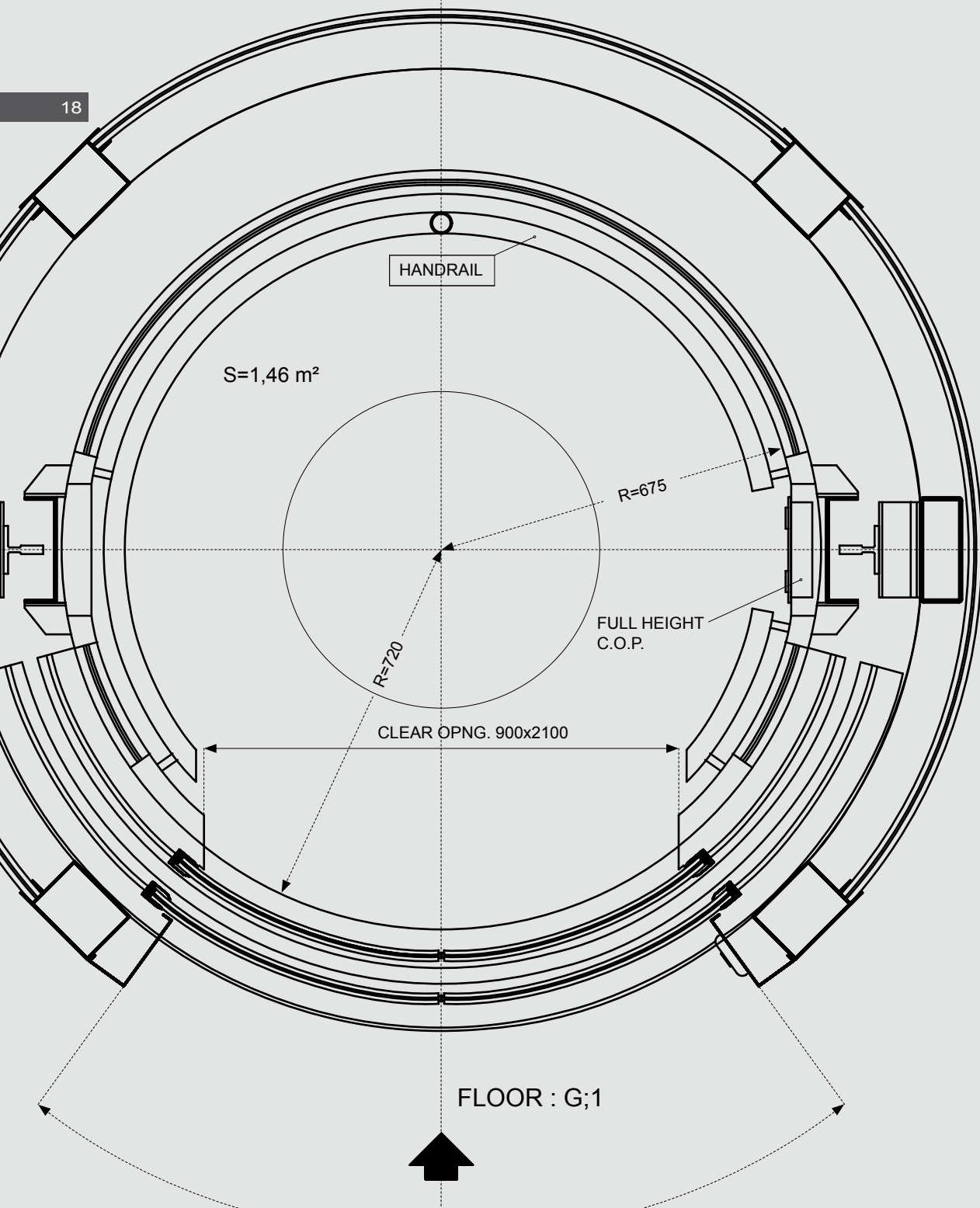

## BESPOKE BY AXEL

Manufactured with  
exceptional quality in mind  
and ingenuity in heart

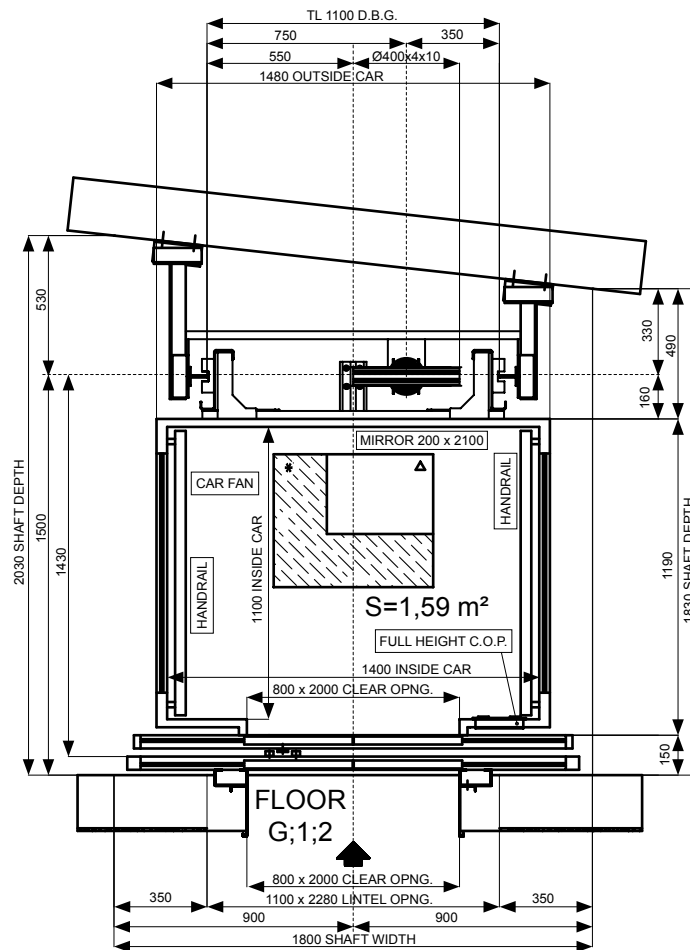

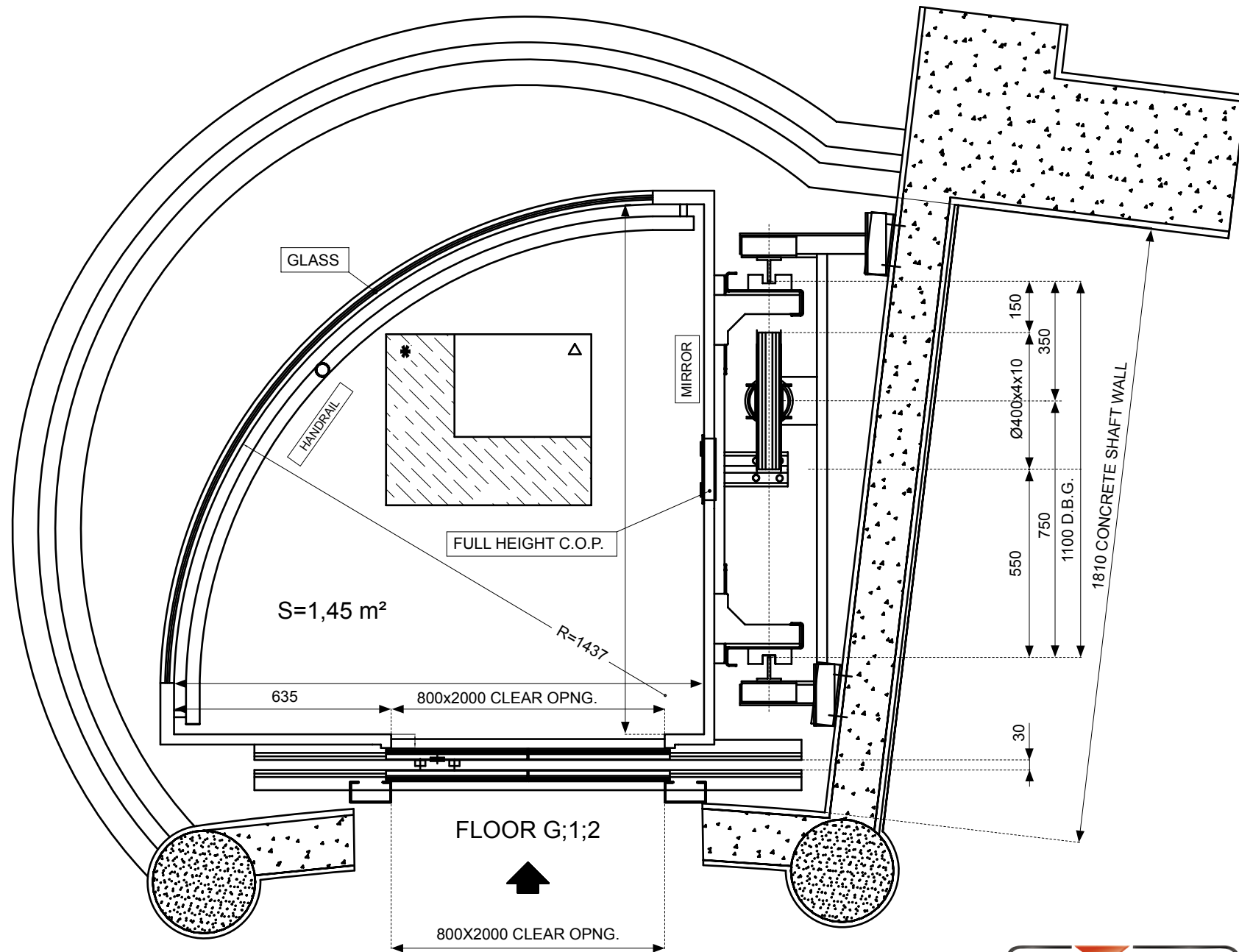

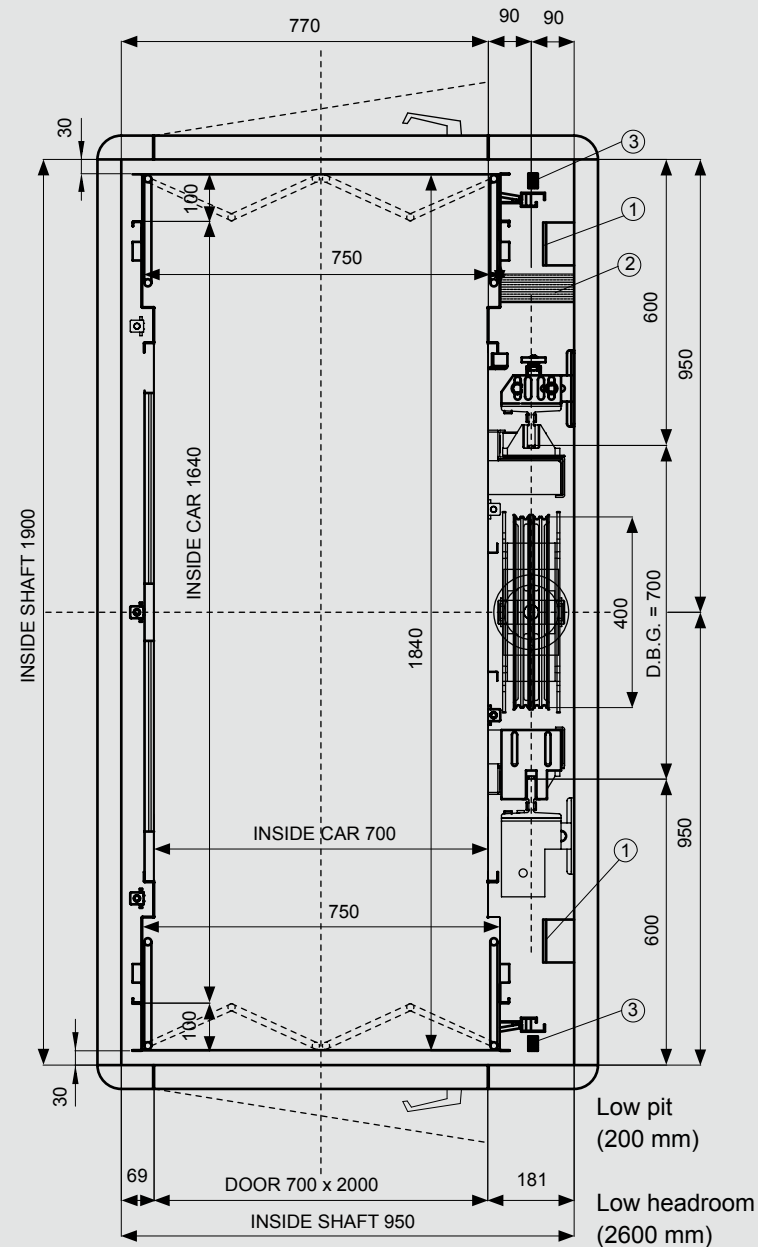
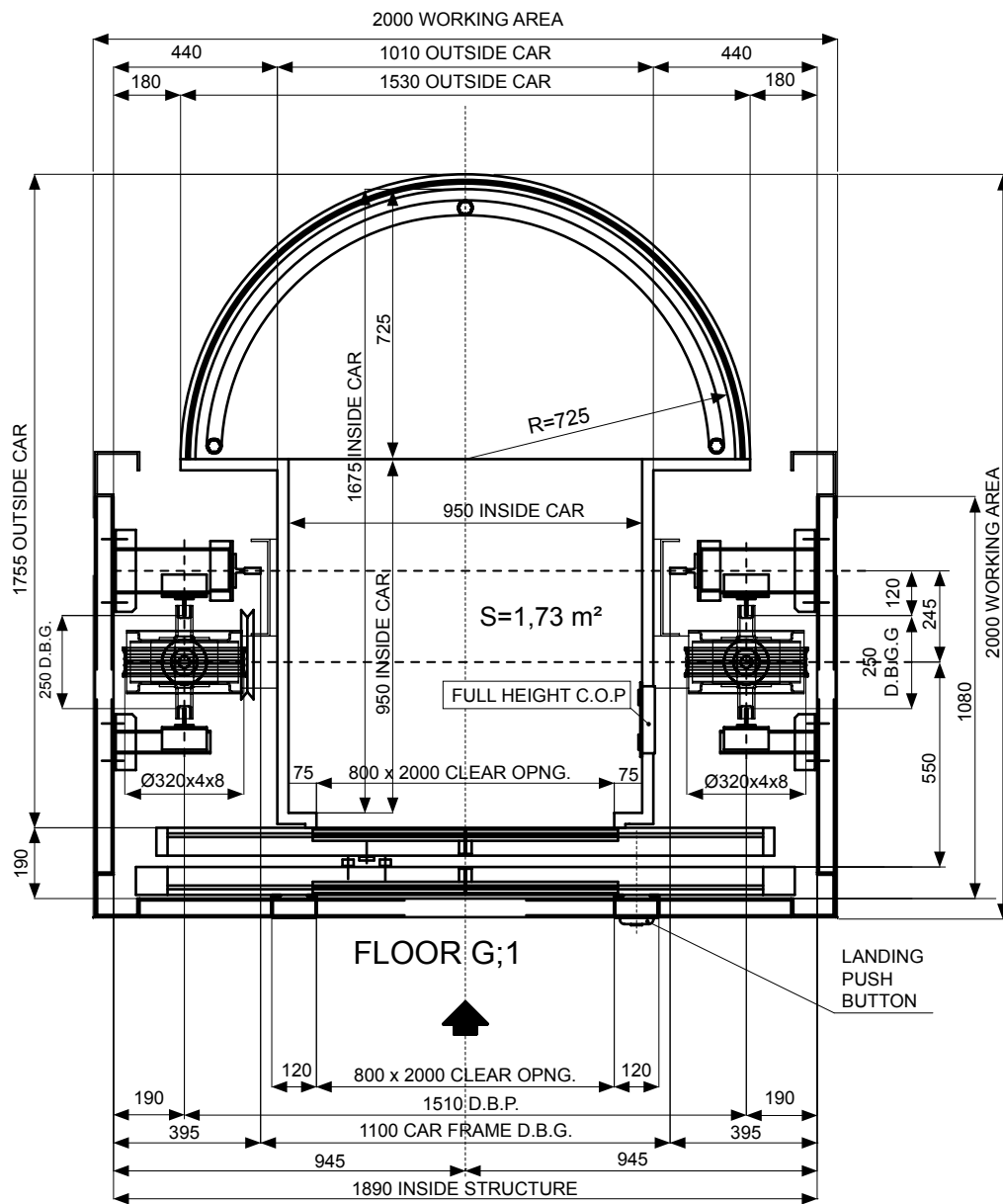

BESPOKE

LIFTS

# CAR FINISHES

## Lightings



SQUARE STANDARD HOLES



SIDE STANDARD HOLES



RECESSED



LEDS SPOTLIGHT



LEDS SPOTLIGHT + FLUORESCENT

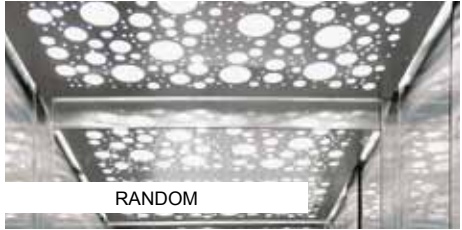

RANDOM



DIAMOND

## Hand Bump rails Skirtings



## Panels Push buttons



# CAR FINISHES | FLOORS

## Bubble rubber floors

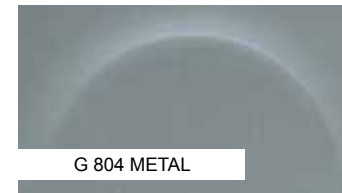
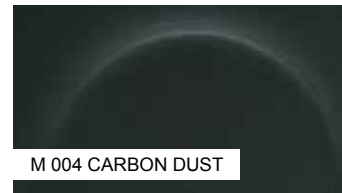
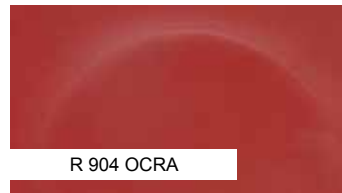

## PVC floors

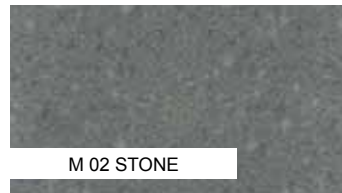

## Granite rock solid floors

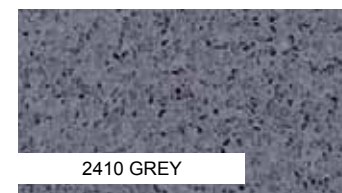
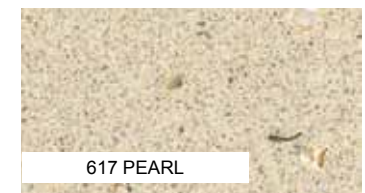
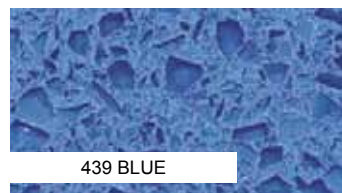

# CAR FINISHES | WALLS

Skin plate  
wall finishes

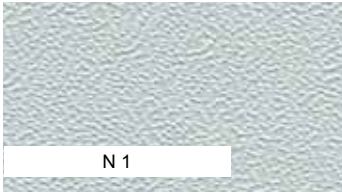
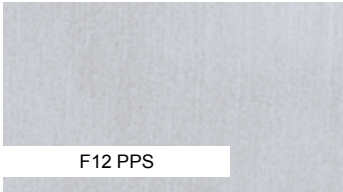
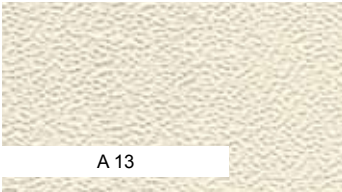
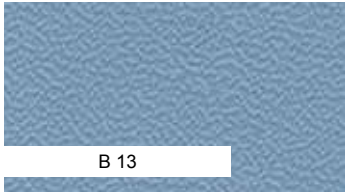

Stainless steel  
wall finishes

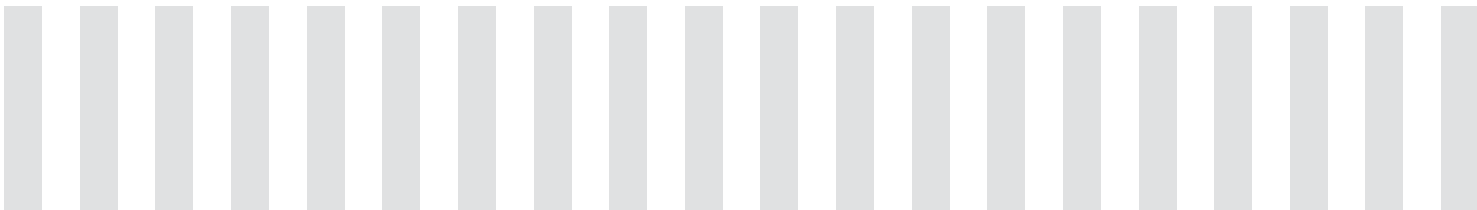
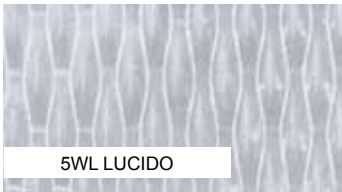

Plastic laminate  
wall finishes  
**STANDARD**



Plastic laminate  
wall finishes  
**SPECIAL**

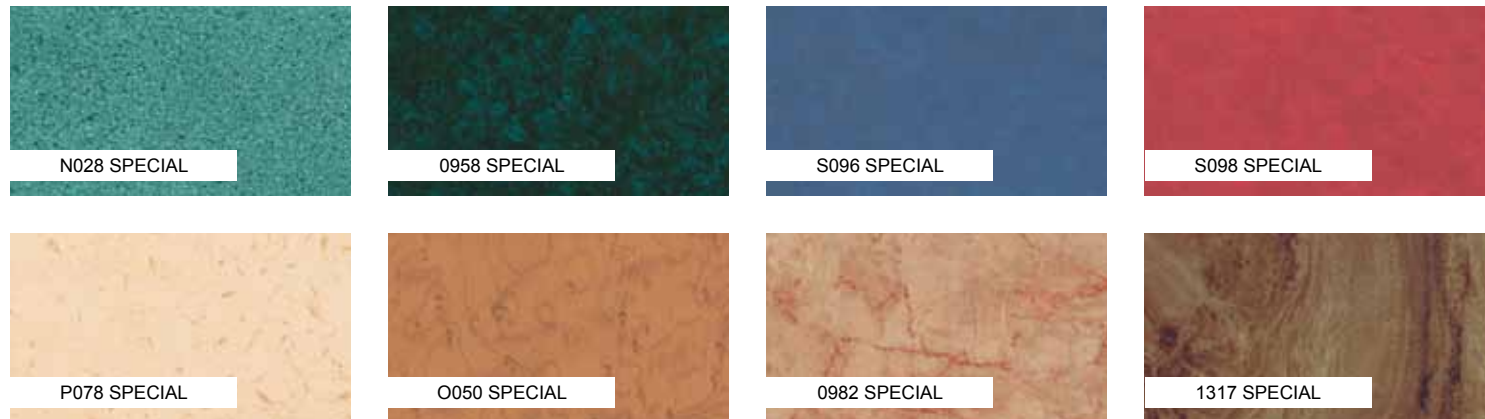

Plastic laminate  
wall finishes  
**SPECIAL**

Influence  
Tendance



B 094



D 022

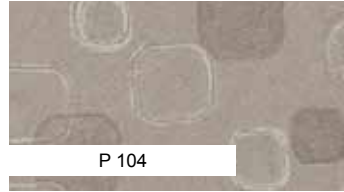

P 104

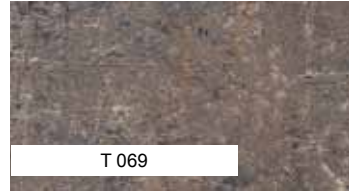

T 069

Influence  
Classique

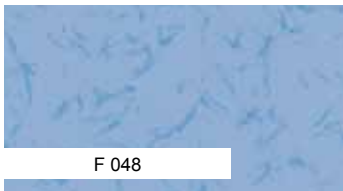

F 048

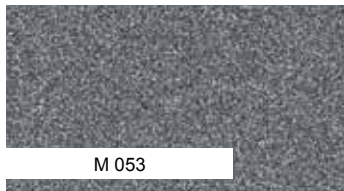

M 053



M 078



S 076

Origine  
Tendance

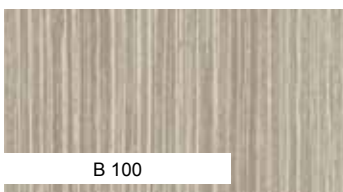

B 100

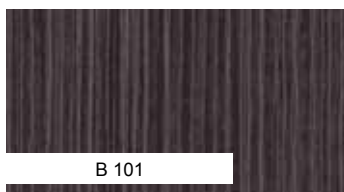

B 101

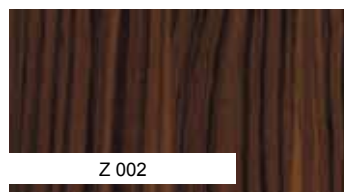

Z 002



Z 008

Origine  
Classique



A 048



C 014



C 092



E 025

Pur Métal

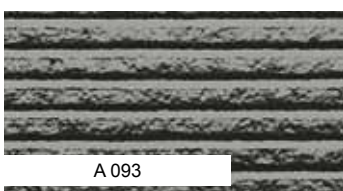

A 093



A 092

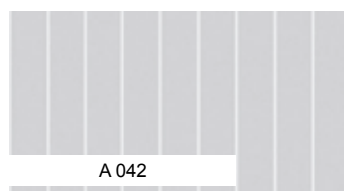

A 042



A 027

Pluralis

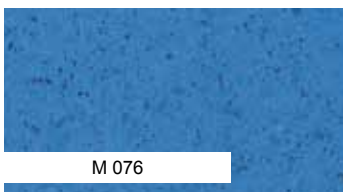

M 076

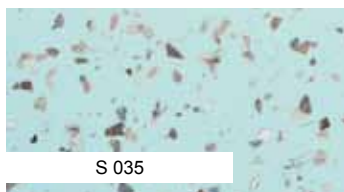

S 035

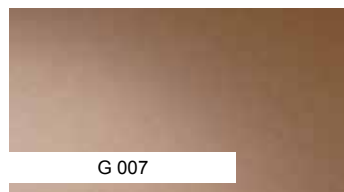

G 007

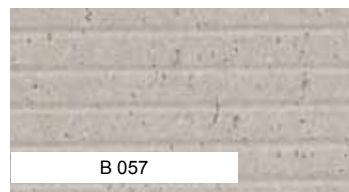

B 057

More than 180  
special finishes on  
[www.axelsrl.com](http://www.axelsrl.com)

# TECHNICAL FEATURES

Note: All specs based on car height of 2200 mm  
 \*: Headroom calculated with an internal car height of 2130 mm  
 Legend: W = width; D = depth; H = height

## Standard hydraulic lifts with machine room

ITEM	UNIT	STANDARD MODELS													
Load	kg	320	400	480	630	800	1000	1500							
Passengers	-	4	5	6	8	10	13	20							
Shaft	W (mm)	1500	1500	1500	1600	1600	1700	1900	1900	1600	2100				
	D (mm)	1500	1600	1700	1600	1800	2000	1800	2000	2500	2800				
Car internal dimensions	W (mm)	900	950	950	1100	1100	1200	1350	1400	1100	1400				
	D (mm)	1000	1100	1300	1200	1400	1600	1400	1600	2100	2400				
Door (H=2000mm)	W (mm)	800	800	800	800	800	800 / 900	800 / 900	900 / 1100						
Speed	m/s	0.63	1	0.63	1	0.63	1	0.63	1	0.63	1	0.63	1	0.63	1
Pit	mm	1000	1100	1000	1100	1000	1100	1200	1300	1200	1300	1200	1300	1400	1500
Headroom*	mm	3400	3500	3400	3500	3400	3500	3400	3500	3400	3500	3400	3500	3400	3500

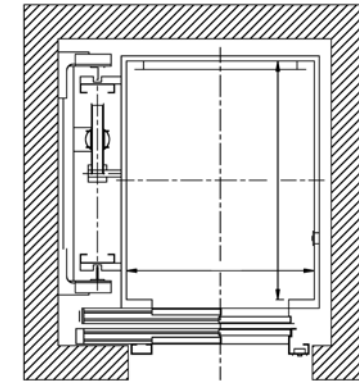

## Hydraulic MRL in pit with extractable controller

CONTROLLER					
ITEM	W (mm)	D (mm)	H (mm)		
"A"	220	325	1640		
ITEM	UNIT	MODELS			
Load	kg	480	630*	1000*	1000*
Passengers	-	6	8	13	13
Shaft	W (mm)	1650	1650	1650	1850
	D (mm)	1700	1800	2500	2500
Car internal dimensions	W (mm)	950	1100	1100	1100
	D (mm)	1300	1400	2100	2100
Door (H=2000mm)	W (mm)	800	800	800	900
Speed	m/s	0.62	0.62	0.50	0.50
Pit	mm	1200	1200	1200	1200
Headroom*	mm	3400	3400	3400	3400

\* 630 kg: travel 12000 mm max  
 \*1000 kg: travel 6000 mm max

## Hydraulic MRL in pit with recessed controller

CONTROLLER					
ITEM	W (mm)	D (mm)	H (mm)		
"B"	300	170	2220		
ITEM	UNIT	MODELS			
Load	kg	480	630*	1000*	1000*
Passengers	-	6	8	13	13
Shaft	W (mm)	1500	1560	1900	1650
	D (mm)	1700	1800	2000	2500
Car internal dimensions	W (mm)	950	1100	1400	1100
	D (mm)	1300	1400	1600	2100
Door (H=2000mm)	W (mm)	800	800	800 / 900	
Speed	m/s	0.62	0.62	0.50	0.50
Pit	mm	1200	1200	1200	1200
Headroom*	mm	3400	3400	3400	3400

\* 630 kg: travel 12000 mm max  
 \*1000 kg: travel 6000 mm max

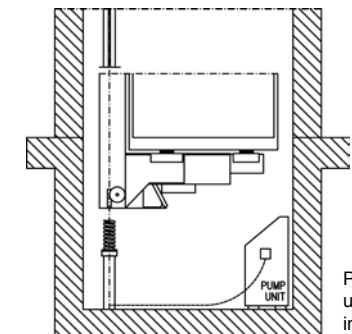
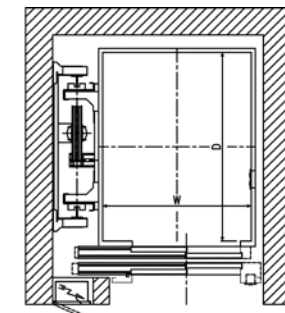

Pump unit in pit

Note: All specs based on car height of 2200 mm  
 \*: Headroom calculated with an internal car height of 2130 mm  
 Legend: W = width; D = depth; H = height

### Standard hydraulic lifts with machine room

ITEM	UNIT	STANDARD MODELS											
Load	kg	320	400	480	630	800	1000						
Passengers	-	4	5	6	8	10	13						
Shaft	W (mm)	1500	1500	1500	1600	1600	1700	1900	1900	1900	1600		
	D (mm)	1500	1600	1700	1600	1800	2000	1800	2000	2000	2500		
Car internal dimensions	W (mm)	900	950	950	1100	1100	1200	1350	1400	1100			
	D (mm)	1000	1100	1300	1200	1400	1600	1400	1600	2100			
Door (H=2000mm)	W (mm)	800	800	800	800 / 900	800 / 900	800 / 900						
Speed	m/s	0.63	1	0.63	1	0.63	1	0.63	1	0.63	1	0.63	1
Pit	mm	1000	1100	1000	1100	1000	1100	1200	1300	1200	1300	1200	1300
Headroom*	mm	3400	3500	3400	3500	3400	3500	3400	3500	3400	3500	3400	3500
Motor power	kW	7.7	11	9.5	14.7	9.5	18.4	12.5	22	14.7	29.4	18.4	29.4
Current	A	19	26.6	21.9	31.8	21.9	39.9	28.5	48	31.8	63.7	39.9	63.7

### 3 MRL cabinets available



MODEL	I	II	III
W (mm)	870	950	100
D (mm)	400	570	650
H (mm)	2100	2100	2100

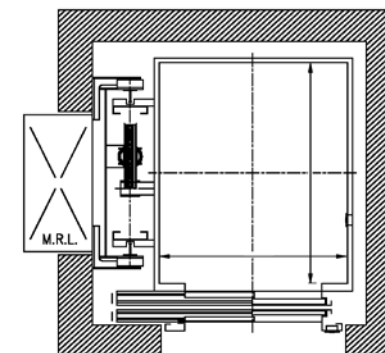

### Standard electrical lifts with machine room on top

ITEM	UNIT	STANDARD MODELS																				
Load	kg	320	400	480	630	800	1000	1500														
Passengers	-	4	5	6	8	10	13	20														
Shaft	W (mm)	1500	1500	1500	1600	1600	1700	1800	1900	1700	2200											
	D (mm)	1500	1700	1900	1800	2000	2200	2000	2200	2500	2800											
Car internal	W (mm)	900	950	950	1100	1100	1200	1350	1400	1100	1400											
	D (mm)	1000	1100	1300	1200	1400	1600	1400	1600	2100	2400											
Door (H=2000mm)	W (mm)	800	800	800	800	800	800 / 900	800 / 900	800 / 900	900 / 1100												
Speed	m/s	0.6	1/■	1.6■	0.6	1/■	1.6■	0.6	1/■	1.6■	0.6	1/■	1.6■	0.6	1/■	1.6■	0.6	1/■	1.6■	0.6	1/■	1.6■
Pit	mm	1100	1100	1400	1100	1100	1400	1100	1100	1400	1100	1100	1400	1100	1100	1400	1100	1100	1400	1100	1100	1400
Headroom*	mm	3400	3450	3600	3400	3450	3600	3400	3450	3600	3400	3450	3600	3400	3450	3600	3400	3450	3600	3400	3450	3600
Motor Power	kW	3.0	3.3/■ 3.3	4.3	3.3	4.0/■ 4.0	6.4	4.0	5.0/■ 4.3	7.9	4.4	6.0/■ 5.8	9.5	6.4	8.5/■ 7.9	11.5	7.20	11.2/■ 9.5	13.5	11.2	14.2/■ 13.5	19.1

2 speed motors: 0.6/0.15 - 1.00/0.25 m/s  
 ■ Value with VVF motor control

## ECLIPSE: Machine Roomless Lift

ITEM	UNIT	STANDARD MODELS												
Load	kg	480			630			800			1000		1000	
Passengers	-	6			8			10			13		13	
Shaft	W (mm)	1450			1600			1850			1950		1800	
	D (mm)	1650			1800			1850			2050		2450	
Car internal dimensions	W (mm)	950			1100			1350			1400		1100	
	D (mm)	1300			1400			1400			1600		2100	
Door (H=2000mm)	W (mm)	800			800 / 900			800 / 900			900		900	
Speed	m/s	0.62	1	1.5	0.62	1	1.5	0.62	1	0.62	1	0.62	1	
Pit	mm	1250	1300	1400	1250	1300	1400	1350	1400	1350	1400	1350	1400	
Headroom*	mm	3400	3450	3600	3400	3450	3600	3400	3450	3400	3450	3400	3450	
Motor power	kW	3.7	6 / ■ 5	7.5	4.7	7.7 / ■ 6.4	9.6	6	9.8 / ■ 8.2	7.6	12.3 / ■ 10.2	7.6	12.3 / ■ 10.2	
Current	A	7.1	11.5 / ■ 9.6	14.4	9.2	14.8 / ■ 12.3	18.5	11.7	18.9 / ■ 15.7	14.6	23.6 / ■ 19.6	14.6	23.6 / ■ 19.6	

■ Value with VVF motor control

## CONSOL: Machine Roomless Lift

ITEM	UNIT	1:1								2:1															
Load	kg	480				630				800				1000				1000				1200			
Passengers	-	6				8				10				13				13				16			
Shaft	W (mm)	1500				1600				1700				1920				1620				2020			
	D (mm)	1700				1750				1950				1950				2450				2150			
Car internal dimensions	W (mm)	950				1100				1200				1400				1100				1500			
	D (mm)	1350				1400				1600				1600				2100				1800			
Door (H=2000mm)	W (mm)	800				800 / 900				800 / 900				900				900				900			
Speed	m/s	0.6 / 0.8	0.6 / 1	1.2 / 1.6	0.6 / 0.8	1	1.2 / 1.6	0.6 / 0.8	1	1.2	0.6	1	0.6	1	0.6	1	0.6	1	0.6	1	0.6	1			
Pit	mm	1100	1150	1200	1100	1150	1200	1100	1150	1200	1200	1250	1200	1250	1200	1250	1200	1250	1200	1250	1200	1250			
Headroom*	mm	3350	3450	3500	3350	3450	3500	3350	3450	3500	3350	3450	3350	3450	3350	3450	3350	3450	3350	3450	3350	3450			
Motor power	kW	3.3 / 3.7	4	5.5 / 6.6	3.7 / 4	5.5	6.2 / 9.2	4.8 / 5.5	6.2	7.3	5.5	9.2	5.5	9.2	5.5	9.2	6.2	11							
Current	A	8 / 9	9.6	13.2 / 15.9	9 / 9.6	13.2	15 / 21.5	11.5 / 13.2	15	17.4	13.2	21.5	13.2	21.5	15	27.5									

Note: All specs based on car height of 2200 mm  
\*: Headroom calculated with an internal car height of 2130 mm  
Legend: W = width; D = depth; H = height

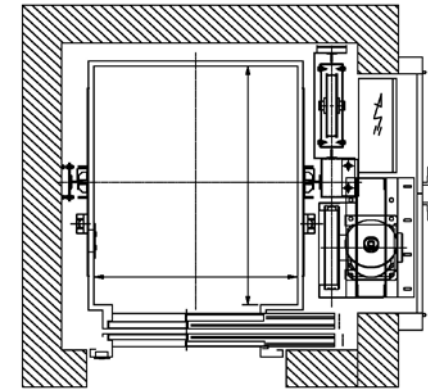

External access to gearbox and controller

Shaft dimensions indicated are for single entrance

Control Board Cabinet Dim. W 260 x D 170 x H 1800

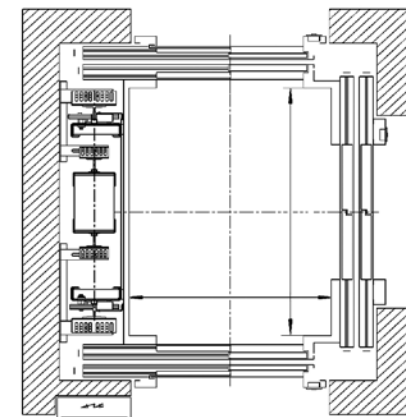

Adjustable beam on top. VVVF drive

**EXEL:** machine roomless lift with gearless motor

Note: All specs based on car height of 2200 mm  
 \*: Headroom calculated with an internal car height of 2130 mm  
 Legend: W = width; D = depth; H = height

ITEM	UNIT	STANDARD MODELS																
Load	kg	480			630			800			1000		1000		1600		2000	
Passengers	-	6			8			10			13		13		21		26	
Shaft	W (mm)	1620			1770			1980			2050		1780		2300		2550	
	D (mm)	1700			1750			1750			2000		2450		2600		3000	
Car internal dimensions	W (mm)	950			1100			1350			1400		1100		1400		1600	
	D (mm)	1300			1400			1400			1600		2100		2400		2600	
Door (H=2000mm)	W (mm)	800			800 / 900			800 / 900			900		900		1200		1300	
Speed	m/s	1	1.6	2	1	1.6	2	1	1.6	1	1.6	1	1.6	1	1.6	1	1.6	
Pit	mm	1300	1350	1400	1300	1350	1400	1400	1450	1400	1450	1400	1450	1400	1450	1400	1450	
Headroom*	mm	3450	3500	3600	3450	3500	3600	3450	3500	3450	3500	3450	3500	3450	3500	3450	3500	
Motor power	kW	4	6.3	8	5	8	10	6.5	10.4	8	13	8	13	10	16	13	21	
Current	A	7.6	12	15	10	15.7	19.6	12.5	20	15.6	25	15.6	25	26	43	36.5	58.8	

Control Board Cabinet Dim. W 260 x D 170 x H 1800

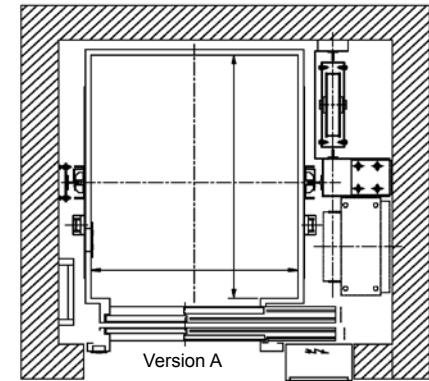

Version B: more shaft space available

**ZEUS:** machine roomless lift with gearless motor

ITEM	UNIT	STANDARD MODELS															
Load	kg	480			630			800			1000			1000			
Passengers	-	6			8			10			13			13			
Shaft	W (mm)	1500	1600	1600	1850	1700	1900	1600									
	D (mm)	1700	1600	1800	1800	2000	2000	2500									
Car internal dimensions	W (mm)	950	1100	1100	1350	1200	1400	1100									
	D (mm)	1300	1200	1400	1400	1600	1600	2100									
Door (H=2000mm)	W (mm)	800			800 / 900			800 / 900			900			900			
Speed	m/s	1	1.2	1.6	1	1.2	1.6	1	1.2	1.6	1	1.2	1.6	1	1.2	1.6	
Pit	mm	1300	1350	1400	1300	1350	1400	1300	1350	1400	1300	1350	1400	1300	1350	1400	
Headroom*	mm	3450	3500	3550	3450	3500	3550	3450	3500	3550	3450	3500	3550	3450	3500	3550	
Motor power	kW	4	6.3	8	5	8	10	6.5	7.7	10.4	8	9.7	13	8	9.7	13	
Current	A	7.6	12	15	10	15.7	19.6	12.5	15	20	15.6	18.7	25	15.6	18.7	25	

Control Board Cabinet Dim. W 260 x D 170 x H 1800

Shaft dimensions indicated are for single entrance

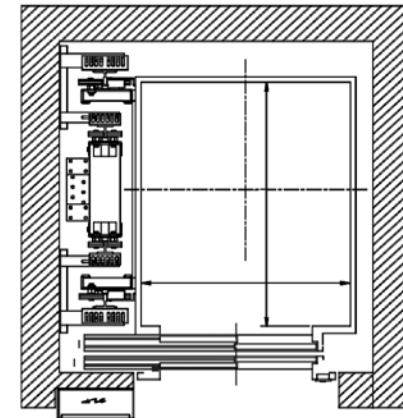

Fire fighting and water proof options available



## COMPANY PROFILE

“Axel srl was founded in 1989 by partners from several European countries with the simple idea of providing customers with a flexible lift solution. Since then, Axel has grown to become synonymous with quality and reliability”.

Headquartered in Milan (Italy), the company is organised in three units: project management, lift and controller manufacturing, thus ensuring flexibility and fast response.

The Axel range is based on an OEM approach of the business: we deliver our product(s) to lift companies and supply them with the technical support needed to service their customers; construction and engineering companies.

It is also not uncommon for Axel to supply and/or develop custom tailored solutions to meet the specific needs of architects and developers.

## QUALITY

Axel was among the first lift companies to obtain ISO 9001 approval (and vision 2000) back in 1996.

In addition, Axel is approved in accordance with the Lift Directive (95/16/EC - schedule XIII). All of our lifts comply with the European standard EN81. We also supply the lifts according to Britain's DDA and other standards on request. Each lift is handled as a separate project and is fully traceable and documented through all the stages of its elaboration.

## WORLDWIDE PRESENCE

Axel has installed thousands of lifts around the world in more than 30 countries. We serve customers in the European Union, Eastern Europe, Middle East, Africa, Asia, Australia and south america either by direct presence or through approved distributors or agents. In addition, with an increase in demand and a stronger market presence Axel Srl has established a new headquarters in North America.

With our primary goal being increasing our market share in core lift products to match our current earned percentage share worldwide.



ITALIAN LIFT PASSION

[WWW.AXELSRL.COM](http://WWW.AXELSRL.COM)



# ITALIAN LIFT PASSION

## LIFT WORLD IRAQ

Iraq-Sulaimaniya  
Salem str. Mihrako Hotel / zi.106  
T. 00964 7701364652 | 00964-7701446100  
lift\_world07@yahoo.com | www.axelsrl-ir.com



UNI EN ISO 9001:2000 - n° 9102.AXE1  
CE CONFORMITY - IMQ N° I 0333  
DIRECTIVE 95/16/CE

**AXEL Srl**  
Via C. Borsini, 14  
20094 Corsico (Milano), Italy  
T. +39 02 4586 2301 | F. +39 02 4501174  
axelsrl@axelsrl.com | www.axelsrl.com

